

RACK-TOWER UPS

2KVA



Features

- High frequency True on-line double conversion technology/ Rack&Tower design for network cabinets.
- DSP (Digital signal processor) control technology
- Active power factor correction (APFC), input power factor up to 0.99.
- Output power factor 0.9
- Wide input voltage range (110V ~ 300Vac) and frequency range (40 ~ 70Hz)
- Auto sensing frequency
- 50 / 60Hz frequency conversion
- Cold start
- Rear ventilation design and variable speed fan
- Effective software and hardware protection

- Linear derating in low voltage input reducing battery discharging time.
- Settable delayed start when power is restored
- Hot-swappable battery.
- Advanced/Smart battery management: Prioritize slow charging to preserve battery life, Digitally controlled charger, automatic floating, equalizing charge control, charger dormancy control, increasing battery life.
- Display panel can be rotated 90°C
- Multiple functions settable via LCD: output voltage, EOD, auto-start, bypass mode, ECO mode and frequency conversion mode
- Multi-platform communications: RS232 (standard), USB/RS485/SNMP/Dry contacts (optional).

Available options

- Optional USB, RS485 card, AS400 dry contacts, SNMP card, SMS alarms, EPO function

Rear Panel

1. AC input socket
2. Battery connector (Optional)
3. Fan
4. USB (Optional)
5. EPO (Optional)
6. RS232
7. Intelligent slot
8. Output sockets

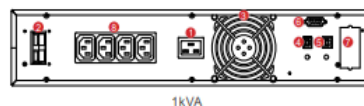

1kVA



2kVA

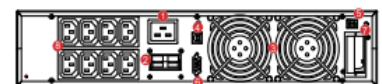

3kVA

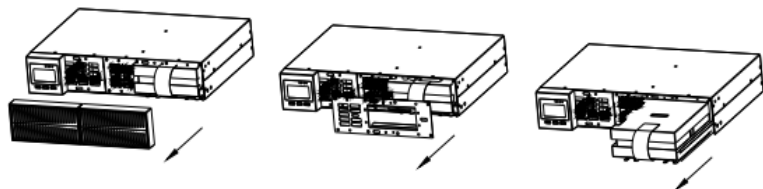

Easy for maintenance, hot-swappable battery

Specifications

MODEL		HD-2KRT
Rated Capacity		2KVA / 1.8KW
INPUT		
Rated voltage		1 phase 200/208/200/220/230/240Vac (selectable)±10%
Voltage range		110 ~ 300Vac 110 ~ 176Vac (linear derating 50% and 100% load); 176 ~ 280Vac(no derating); 280 ~ 300Vac (linear derating 50%)
Frequency		50/60Hz (auto-sensing/settable)
Frequency range		40 ~ 70Hz (45 ~ 55Hz or 54~66Hz)
Power factor		>0.99(100% load)
Bypass voltage		-25% ~+15%(settable)
Total harmonic distortion (THDi)		≤ 3%(linear load), ≤ 6% (non-linear load)
Generator compatibility		Support
OUTPUT		
Voltage		1 phase 208/220/230/240Vac (settable via LCD) ±1%
Frequency		50/60Hz±10%(synchronized main range); 50/60Hz ± 0.1Hz (battery mode)
Waveform		Pure sine wave
Power factor		0.9
Total harmonic distortion (THDv)		≤ 2% (linear load), ≤ 5% (non-linear load)
Crest factor		3:1
Output socket		IEC C13 or unniversal socket
Overload	Inverter mode	105% ~ 130% for 1 min; 130% ~ 150% for 30s; >150% for 300ms and transfer to bypass.
	Bypass mode	125%~150% for 1min, > 150% for 300ms and shut down immediately
BATTERIES		
Type		Hyundai VRLA 12V(sealed lead-acid maintenance free battery)
DC voltage		48V
Inbuilt battery		4*9Ah
Backup time at full load		≥5 mins
Charging current(max)		1A
Charger output voltage		54.2±0.8
Max connect external battery module quantity		2
Recharge time	90% capacity restored in 5 hours	
	Advanced battery management (auto transfer to continuous charging). Prioritize slow charging to preserve battery life.	
SYSTEM		
Efficiency	≥ 91% (Mains mode)	
	≥ 88% (Battery mode)	
	≥ 96% (ECO mode)	
Transfer time		Mains mode to battery mode: 0ms, Inverter mode to bypass mode & back: <4ms (typical)

Protections	Short-circuit, overload, overtemperature, overvoltage, bypass, surge, battery, battery discharge protection and fan testing protection
Communications	RS232 (standard), UpsSmartView monitoring software via RS232 connection-auto shutdown or control PC-server before UPS stop working; Build-in surge protection; USB/dry contacts/EPO/SNMP (optional); Supports Windows®98/2000/2003/XP/Vista/2008/7/8/10/Linux/Unix/MAC
Operation mode	Standby mode, bypass mode, AC mode, Battery mode, Battery self test mode, ECO mode, shutdown mode, CUCF mode, Fault mode
LCD+LED Display control	Display panel can be rotated 90°C; Ups operating status via LCD color: Load, battery, input, output, bypass, charging, discharging, mute, fan, fault...;
	LED warning with sound and flashing light when ups is wrong shutdown, overload, low battery, fault
Standards	EN 62040; EN 61000
OTHERS	
Operating/Storage temperature	0°C ~ 40°C/ -25°C ~ 55°C (without batteries)
Relative humidity	0 ~ 95% (non-condensing)
IP rating	IP20
Noise level at 1m	< 50dB
Dimension (W*D*H) (mm) 2U	88*440*430
Net weight (kg)	18.7

- All specifications are subject to change without notice.

