

1-3 KVA RACK (1:1)



Features

- High frequency on-line double conversion technology
- DSP (digital signal processing) control technology
- Active power factor correction (APFC) input power factor up to 0.99
- Output power factor 0.9/1.0
- Wide input voltage range (110v~300VAC) and frequency range (40-70Hz)
- Auto sensing frequency
- 50-70Hz frequency conversion
- Cold start
- Rear ventilation design and variable speed fan
- Effective software and hardware protection
- Quick and stable charging, 90% capacity restored in 3h (KRi model)
- Linear derating in low voltage input reducing battery discharging times
- Settable delayed start when power is restored
- Hot-swappable battery (KRi model)
- Advanced battery management (ABM)
- Multiple functions settable via LCD: output voltage, EOD, auto- star, bypass mode
- Multi-plaform communications: RS232 (Stardard), USB/ RS485, SNMP, dry contact (optional)
- Optional USB, RS485 Card, AS400 dry contact, SNMP card, EPO function, MBS (external maintenance bypass switch)

Rear Panel

- 1.AC Input Socket
- 2.Battery connector (Optional)
- 3.Fan
4. USB (optional)
- 5.EPO (optional)
- 6.RS232
- 7.Intelligent slot
8. Output sockets

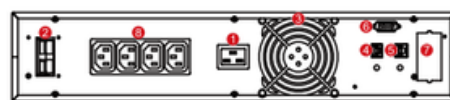

1kVA (S)



2kVA(S)

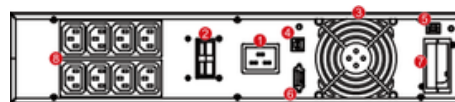

3kVA (S)

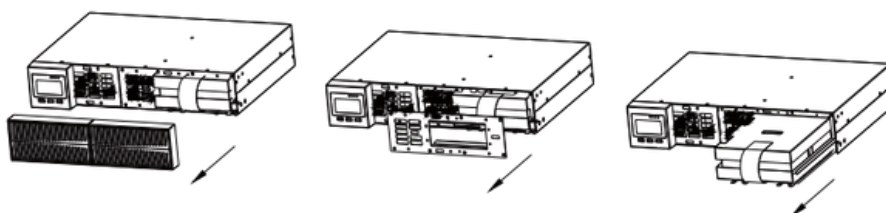

Easy for maintaince, hot-swappable battery for S model

Spectifications

MODEL	HD901RTS		HD901RTH		HD902RTS		HD902RTH		HD903RTS		HD903RTH	
Capacity	1kVA/0.9kW or 1kVA/1kW (optional)				2kVA/1.8kW or 2kVA/2kW (optional)				3kVA/2.7kW or 3kVA/3kW (optional)			
INPUT												
Rated voltage	208 / 220 / 230 / 240 Vac											
Voltage range	110 ~ 176 Vac (linear derating between 50% and 100% load); 176 ~ 280 Vac (no derating); 280 ~ 300 Vac (derating 50%)											
Frequency	40~70 Hz (auto-sensing)											
Power factor	≥ 0.99											
Bypass voltage range	-25% - +15% (settable)											
THDi	≤ 6%											
OUTPUT												
Voltage	208 / 220 / 230 / 240 Vac (settable via LCD)											
Voltage regulation	± 1%											
Frequency	45 ~ 55 Hz or 55 ~ 65 Hz (synchronized range); 50 / 60 Hz ± 0.1 Hz (battery mode)											
Waveform	Pure sine wave											
Power factor	0.9 / 1.0											
THDv	≤ 2% (linear load); ≤ 5% (non-linear load)											
Crest factor	3:1											
Overload	105% ~ 125% for 1 min, 125% ~ 150% for 30 s, > 150% for 300 ms											
BATTERIES												
DC voltage	24V	36V	24V	36V	48V	72V	48V	72V	72V	96V	72V	96V
Inbuilt battery	2x9Ah	3x7Ah	/	/	4x9Ah	6x7Ah	/	/	6x9Ah	8x7Ah	/	/
Charging current (max.)	S model: 1A, H model: 6A											
Recharger time	S model: 90% capacity restored in 3 hours; H: depend on the capacity of battery											
SYSTEM												
Efficiency	≥ 90% (Mains mode)				≥ 91% (Mains mode)				≥ 92% (Mains mode)			
	≥ 85% (Battery mode)				≥ 86% (Battery mode)				≥ 87% (Battery mode)			
	≥ 95% (ECO mode)				≥ 96% (ECO mode)				≥ 97% (ECO mode)			
Transfer time	Mains mode to battery mode: 0 ms Inverter mode to bypass mode: 4 ms (typical)											
Protections	Short-circuit, overload, overtemperature, battery discharge protection and fan testing protection											
Communications	RS232, intelligent slot (standard). USB / RS485 / dry contacts/ SNMP card (optional)											
Display	LCD + LED											
Standards	EN 62040-1, EN 62040-2, EN 61000-3-2, EN 61000-3-3, IEC 61000-4-2, IEC 61000-4-3, IEC 61000-4-4, IEC 61000-4-5, IEC 61000-4-6, IEC 61000-4-8, IEC 61000-4-11, IEC 61000-2-2, IEC 62040-2, IEC 62040-1											
OTHERS												
Operating temperature	0° C ~ 40°C											
Storage temperature	-25° C - 55°C (without batteries)											
Relative humidity	0-95% (non-condensing)											
Altitude	≤ 1000 m, derating 1% for each additional 100 m											
IP rating	IP 20											
Noise level at 1m	≤ 50 dB											
Dimensions (WxDxH) (mm)	440x338x88	440x430x88	440x468x88	440x468x88	440x430x88	440x560x88	440x468x88	440x468x88	440x560x88	440x468x88(UPS) 440x468x88(BAT)		440x468x88
Net weight(kg)	10.6	15.5	7.6	7.6	18.7	25.6	9.7	9.7	26.8	9.45(UPS) 27.2(BAT)	10	10.1

- All specifications are subject to change without notice
- Custom-made specifications are acceptable